

PREMIUM LEASE SPACE



SUITE 204 - VISUALIZATION

SUITE 204 | KENOSHA INNOVATION CENTER



1,244 SF
FULL SERVICE GROSS
SHELL SPACE

\$30
/sq ft



2ND FLOOR
PREMIUM
LOCATION



**FLEXIBLE
LAYOUT**
YOUR VISION



**IMMEDIATE
AVAILABILITY**



**BUILT FOR
INNOVATION**

KENOSHA INNOVATION CENTER (KIC)

A state of the art facility built to inspire innovation, collaboration, and economic growth in the heart of Kenosha, Wisconsin. This three story, 64,000 square foot building serves as the cornerstone of the 107 acre Kenosha Innovation Neighborhood (KIN), a mixed-use redevelopment. Tenants can take advantage of a variety of amenities, including the Launch Pad, conference rooms, the Skyline Lounge, and an outdoor amphitheater.

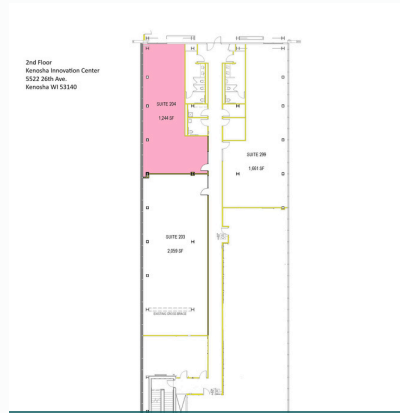

Suite 204- Floor Plan



MODERN INDUSTRIAL DESIGN

SPACE HIGHLIGHTS



Floor-to-ceiling windows with abundant natural light



Open, flexible shell space ready for your custom buildout



Modern industrial design with exposed ceilings



Access to building amenities including the Launch Pad, Skyline Lounge and more

AMENITIES & COMMUNITY



LAUNCH PAD
Event &
Innovation
Space



**CONFERENCE
ROOMS**
Meet. Connect.
Collaborate.



**107 ACRE
INNOVATION
NEIGHBORHOOD**
A Thriving Hub for
Business & Growth



SKYLINE LOUNGE
Relax. Recharge.
Inspire.



**OUTDOOR
AMPHITHEATER**
Events. Gatherings.
Community.

**WHERE IDEAS BECOME
COMPANIES,
COMPANIES CREATE JOBS AND
OPPORTUNITIES MULTIPLY**



DAVID SALINAS
KIC Director



262-467-2682



KIC@innovateKIN.org



5522 26th Ave, Kenosha, WI



INNOVATEKIN.ORG

INNOVATE. COLLABORATE. GROW